

APPENDIX B

LEGEND / NOTES.

Key continued:

- LC Existing lighting column
- LC Proposed lighting column relocation. Liaison with LBS Street Lighting required.
- EG Existing gully - Refer to 500 series
- PG Proposed new gully - Refer to series 500 series

Unbound footway construction (Yorkstone flags) to tie into existing footway levels - Refer to standard detail A

Lapa LPA 3B 2 gabion basket bench by Furnitube or similar approved - Refer to standard detail U

New Ferrocast Manchester polyurethane bollard with square root and socket by Marshalls or similar approved. To be installed on a F foundation as Volume 2, Annex D, drawing LBS/C/030

Highway boundaries - install metal studs at consistent longitudinal spacing of 600-800mm with one at least every paving bond row as SSDM Typical Detail Register, drawing LBS/C/010, Type I.

Utility covers and frames to be adjusted to match new carriageway/footway levels. All footway covers to be converted into recess covers except at vehicle crossovers. See note 10 for covers at traffic carpets

Footway channel formed from 300mm wide sections of cut Yorkstone natural stone paving flags - Refer to standard detail G

Type designation K15-T1(N/S) standard granite kerb as Volume 2, Annex D, drawing LBS/C/005 and Appendix 11/1. Colour to be silver grey as Appendix 11/1. Upstand to be 150mm above footway level for tree pit and low level landscape area delineation. To be installed on a M1 foundation as Volume 2, Annex D, drawing LBS/C/010. All concrete shall be ST4 as cl.2602.

Double height edge kerb formed of type designation K30-T1(N/S) kerbs as Volume 2, annex D, drawing LBS/C/005 and Appendix 11/1. Colour to be silver grey as Appendix 11/1. Lower and upper kerb upstand to be respectively 50mm and 100mm above carriageway level. To be installed on a Type M foundation as Volume 2, Annex D, drawing LBS/C/010. All concrete shall be ST4 as cl.2602. Refer to standard detail I.

Type designation KA-150(90/N) granite 90 degree angle kerb as Volume 2, Annex D, drawing LBS/C/005 and Appendix 11/1. Upstand to be 150mm above footway level for low level landscape area delineation. To be installed on a M1 foundation as Volume 2, Annex D, drawing LBS/C/010. All concrete shall be ST4 as cl.2602.

Type designation KQ-30(N/X15) granite splay quadrant kerb as Volume 2, Annex D, drawing LBS/C/005 and Appendix 11/1. Upstand to be 150mm above footway level for low level landscape area delineation. To be installed on a M1 foundation as Volume 2, Annex D, drawing LBS/C/010. All concrete shall be ST4 as cl.2602.

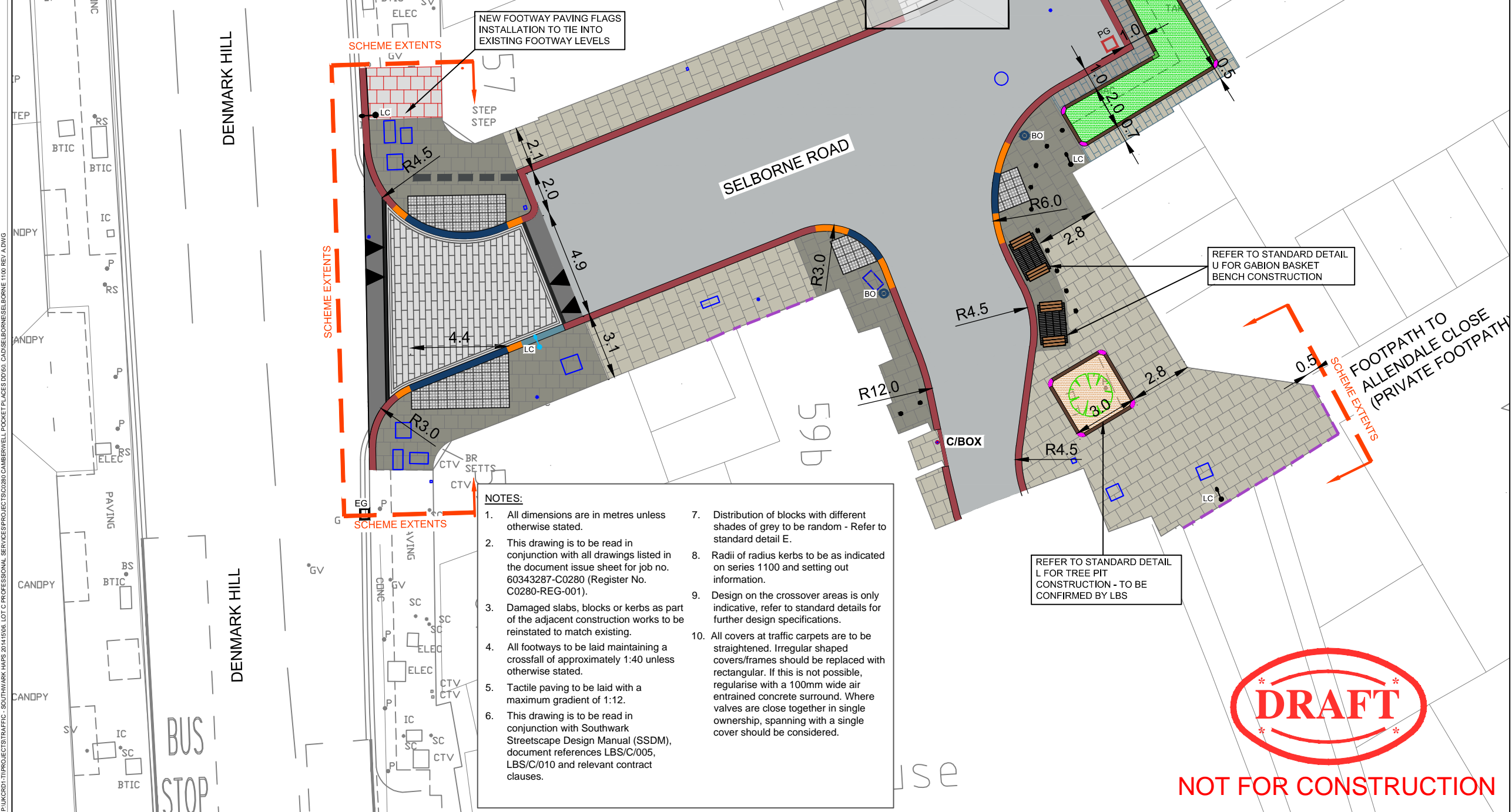
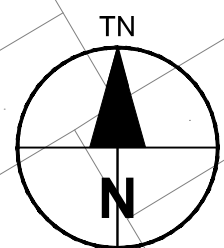

- Type designation K30-T1(N/S) kerb as Volume 2, annex D, drawing LBS/C/005 and Appendix 11/1. Colour to be silver grey as Appendix 11/1. Upstand to be 100mm. To be installed on a M1 foundation as Volume 2, Annex D, drawing LBS/C/010. All concrete shall be ST4 as cl.2602
- Type designation K30-T1(N/S-D1) kerb as Volume 2, annex D, drawing LBS/C/005 and Appendix 11/1. Colour to be silver grey as Appendix 11/1. Upstand to be from 0 to 60mm. To be installed on a M1 foundation as Volume 2, Annex D, drawing LBS/C/010. All concrete shall be ST4 as cl.2602
- Type designation K30-T1(N/S) granite kerb as Volume 2, annex D, drawing LBS/C/005 and Appendix 11/1. Colour to be silver grey as Appendix 11/1. Upstand to be 60mm. To be installed on a M1 foundation as Volume 2, Annex D, drawing LBS/C/010. All concrete shall be ST4 as cl.2602
- Type designation K30-T1(L/S) granite kerb as Volume 2, Annex D, drawing LBS/C/005 and Appendix 11/1. Colour to be silver grey as Appendix 11/1. Upstand to be 0mm (flush). To be installed on a Q1 foundation as Volume 2, Annex D, drawing LBS/C/010. All concrete shall be ST4 as cl.2602.
- Type designation K15-T1(N/S) kerb as Volume 2, annex D, drawing LBS/C/005 and Appendix 11/1. Colour to be silver grey as Appendix 11/1. Upstand to be 100mm. To be installed on a M1 foundation as Volume 2, Annex D, drawing LBS/C/010. All concrete shall be ST4 as cl.2602
- Carriageway resurfacing - Refer to standard detail D
- Unbound footway construction (Yorkstone flags) - Refer to standard detail A
- Bound footway construction (Yorkstone flags) - Refer to standard detail B
- Traffic Carpet construction (anti-shift units) - Refer to standard detail E
- Unbound footway construction (granite setts) - Refer to standard detail F1
- Bound footway construction (granite setts) - Refer to standard detail F2
- Blister tactile paving construction (Yorkstone) - Refer to standard detail C
- New raised edge low level landscape area - Refer to standard detail H and series 3000
- New tree and tree pit construction - Refer to standard detail L
- Type designation E-NS(150) granite edging kerb as Volume 2, Annex D, drawing LBS/C/005 and Appendix 11/1. Colour to be silver grey as Appendix 11/1. Upstand to be 0mm. To be installed on a Q1 foundation as Volume 2, Annex D, drawing LBS/C/010. All concrete shall be ST4 as cl.2602

- NOTES:**
- All dimensions are in metres unless otherwise stated.
 - This drawing is to be read in conjunction with all drawings listed in the document issue sheet for job no. 60343287-C0280 (Register No. C0280-REG-001).
 - Damaged slabs, blocks or kerbs as part of the adjacent construction works to be reinstated to match existing.
 - All footways to be laid maintaining a crossfall of approximately 1:40 unless otherwise stated.
 - Tactile paving to be laid with a maximum gradient of 1:12.
 - This drawing is to be read in conjunction with Southwark Streetscape Design Manual (SSDM), document references LBS/C/005, LBS/C/010 and relevant contract clauses.
 - Distribution of blocks with different shades of grey to be random - Refer to standard detail E.
 - Radii of radius kerbs to be as indicated on series 1100 and setting out information.
 - Design on the crossover areas is only indicative, refer to standard details for further design specifications.
 - All covers at traffic carpets are to be straightened. Irregular shaped covers/frames should be replaced with rectangular. If this is not possible, regularise with a 100mm wide air entrained concrete surround. Where valves are close together in single ownership, spanning with a single cover should be considered.

DRAFT

NOT FOR CONSTRUCTION

REV	DATE	REVISION DESCRIPTION / DETAILS	DRN BY	CHKD BY	APRVD BY
A		NEW TREE AND TREE PIT, CHANGES TO FOOTWAY CHANNEL, EXTENT OF PLANTING, FOOTWAY CONSTRUCTION, AND TREE PIT ALIGNMENT FOLLOWING DESIGN QUALITY WORKSHOP	JL		

PROJECT: **CAMBERWELL POCKET PLACES DETAILED DESIGN**

TITLE: **SERIES 1100 - KERBS AND PAVED AREAS SELBORNE ROAD**

CONTRACT NO:	60343287-C0280	DRAWN:	JL
SCALE:	1:200 @ A3	CHECKED:	ABE
DRAWING NO:	60343287-C0280-1100-SR	APPROVED:	AGB
DATE DRAWN:	AUG 2016	REV:	A
DATE ISSUED:	2 SEPT 2016		